

Ilco Cylinder Installation Manual



Always use a manual screwdriver for tightening. DO NOT use an electric screwdriver.



Designed to be used with Ilco cylinder 1599 only.

1. Prepare the cylinder.

1. Attach the tailpiece (b) with the RS engraving to the cylinder (a) (see Figure 1).
2. Setup another cylinder with the attached tailpiece.
In total, prepare two cylinders.

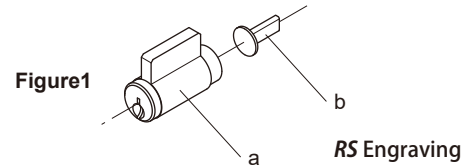

DO NOT install the tailpiece horizontally.



2. Attach the cylinder to the control unit.

1. Remove the screw and plate (c) from the back side of the control unit (see Figure 2).
2. Remove the bag inside and take out the connecting pipe (d) and ring components (e) from the bag.



IMPORTANT: DO NOT remove the bottom plate (f).

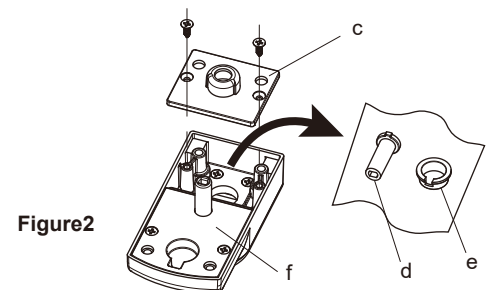

3. Attach the ring component (e) and then the cylinder (a) to the control unit, in that order (see Figure 3).

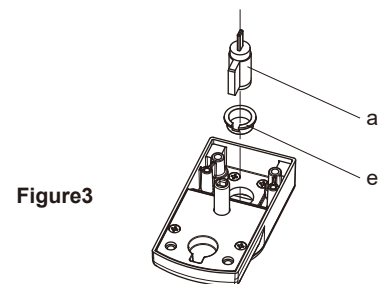

4. Attach the connecting pipe (d) (see Figure 4). Make sure the notch on the connecting pipe is aligned with the top part of the control unit during installation (g).

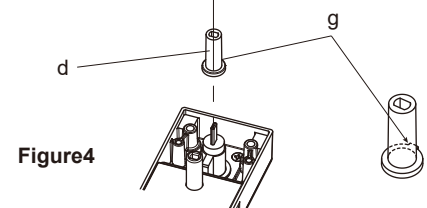

5. Secure the plate (c) with screws (see Figure 5).

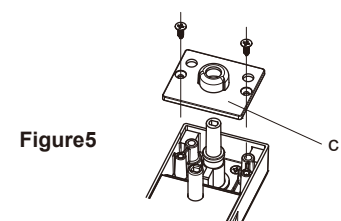

3. Attach the cylinder to the main body.

1. Remove the support bracket (h) and the four screws from the bottom of the main body (see Figure 6).

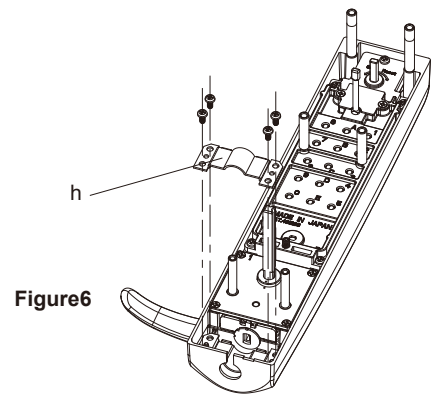

2. Rotate the connecting part (i) and align the marks (○ and ○) on the square spindle section (see Figure 7).
3. Confirm that the hole (j) in the connecting part is oriented vertically.

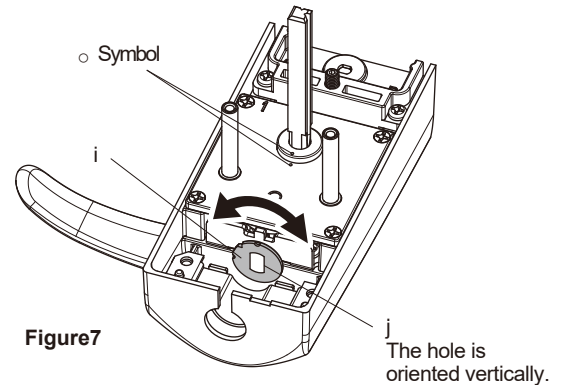

4. With the cylinder head (a) facing upward, insert it into the connecting part (i) (see Figure 8).

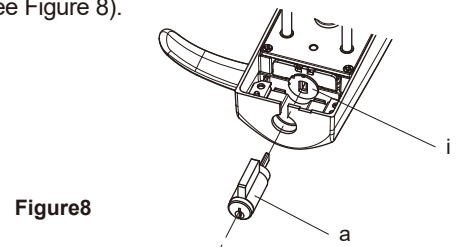

5. Rotate the cylinder (a) to the right (see Figure 9).



DO NOT rotate to the left.

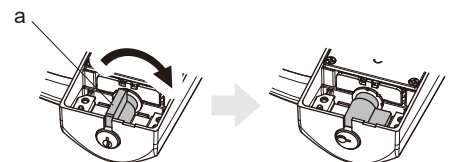

6. Secure the support bracket (h) with four screws (see Figure 10).

